

Contract No. _____

SERVICES AGREEMENT

City of Pascagoula
P.O. Box 908
Pascagoula, MS 39568

Mississippi Power Company
P.O. Box 4079
Gulfport, Mississippi 39502-4079

("MPC")

THIS SERVICES AGREEMENT ("Agreement") is entered into by and between Mississippi Power Company and the above referenced Customer, and is effective on the date it is executed by Customer and accepted by MPC. MPC hereby agrees to perform and provide Customer with the services described hereinbelow ("Services"), on the terms and conditions set-forth on the face page of this Agreement and the reverse side hereof.

<u>Description of Services</u>	<u>Total Charges</u>
Install: (2) Meter points, (22) 75W LED Pendant fixtures, (22) 35" Black Tapered DB Poles with Arlan Bases, (22) Decorative Arms, (3,500') Bored Conduit, (3,800') Conductor, and miscellaneous material to complete project. Location: Ingalls Ave., Pascagoula, MS.	Total \$ 209,406.00

AGREED TO BY:

("Customer")

By: _____
(Signature)

(Name typed or printed)

Title: _____

Date: _____

ACCEPTED BY:

Mississippi Power Company
("MPC")

By: _____
(Signature)

Giff Ormes

(Name typed or printed)

Title: Marketing & Sales Director

Date: _____

1. **Payment.** Customer shall pay or cause to be paid to MPC the full price for the Services upon acceptance of the Project. Payment shall be made net thirty (30) days of invoice date.

2. **Term.** For each Service provided under this Agreement, the Exhibit attached to this Agreement will state the term during which those Services may be provided. This Agreement will continue in effect until the last term contained in any Exhibit to this Agreement expires or is terminated.

3. **Termination.** If Customer fails to make any payment due hereunder, and such failure continues for seven (7) days after said payment is due MPC, then MPC may terminate this Agreement for cause. In the event of such termination, Customer shall pay MPC for all work performed to the date of termination, overhead and profit on all work covered by this Agreement, and demobilization costs.

4. **Limited Warranty.** For a period of ninety (90) days after the completion of the Services, MPC warrants that the Services performed by MPC hereunder, will be performed in a good, professional, workmanlike and competent manner, in conformity with all applicable professional standards. If Customer notifies MPC of any defective or non-conforming Services within ninety (90) days after the completion of the Services, then MPC shall correct or re-perform the defective or non-conforming Services; provided, however, that, MPC's sole obligation and Customer's exclusive remedy for defective or non-conforming Services is for MPC to correct or re-perform the defective or non-conforming Services within ninety (90) days after the completion of the Services, subject to the limitation of liability set forth herein. MPC shall be entitled to rely on the accuracy and currency of information supplied by or at the direction of Customer, or available from generally acceptable reputable sources. MPC's WARRANTY EXPRESSED IN THIS PARAGRAPH IS IN LIEU OF ALL OTHER WARRANTIES EXPRESSED OR IMPLIED, INCLUDING BUT NOT LIMITED TO ANY IMPLIED WARRANTY OF MERCHANTABILITY OR FITNESS FOR A PARTICULAR PURPOSE. CUSTOMER ASSUMES FULL RESPONSIBILITY FOR THE SELECTION OF THE PARTICULAR SERVICES TO BE PERFORMED HEREUNDER BY MPC TO ACHIEVE CUSTOMER'S PURPOSES.

5. **Limitation of Liability.** MPC, its affiliates and parent and their respective agents, representatives, employees, successors and assigns, liability to Customer, its respective successors or assigns, for damages or alleged damages whether arising from breach of this Agreement, breach of warranty, tort or otherwise with respect to the Services performed hereunder by MPC, is limited to and shall not exceed the amount of compensation paid to MPC hereunder for the particular Services out of which the liability arose. In no event shall MPC, its affiliates and parent and their respective agents, representatives, employees or successors and assigns be liable to Customer or any individual or entity for any unforeseeable, indirect, incidental, punitive, consequential or special damages, including without limitation, any loss of revenues or loss of profits.

6. **Independent Contractor.** MPC shall be deemed to be an independent contractor in the performance of the Services hereunder and shall not be considered or permitted to be an agent, servant, joint venturer or partner of Customer. All persons furnished, used, retained or hired by or on behalf of MPC shall be considered to be solely the employees or agents of MPC.

7. **Force Majeure.** MPC shall not be deemed to be in default of any provision of this Agreement or liable for failures in performance resulting from acts or events beyond the reasonable control of MPC. Such acts shall include but not be limited to acts of God, civil or military authority, civil disturbance, war, strikes, fires, other catastrophes, or other "force majeure" events beyond MPC's reasonable control.

8. **Incorporation of Exhibits.** Each Exhibit referenced in and attached to this Agreement is incorporated by reference as if fully set forth herein. In the event of a conflict between the terms of this Agreement and any Exhibit, this Agreement shall control.

9. **Indemnification.** To the extent permitted by law, Customer party shall and hereby does indemnify and hold harmless MPC, its parent and affiliates, their respective officers, directors, employees and agents, from and against any and all losses, damages, injuries (including death), causes of action, claims, demands and expenses, including reasonable legal fees and expenses, arising out of a hazardous waste, spill or condition on the Customer's property, or due to the negligence or willful misconduct of Customer. Such indemnification shall survive the termination or expiration of this Order.

10. **Governing Law and Jurisdiction.** This Agreement shall be governed by and construed in accordance with the Laws of the State of Mississippi, United States of America (without giving effect to principles of conflicts of laws). The interested party hereby submits to the non-exclusive jurisdiction of the United States District Court for the Southern District of Mississippi and to the State Courts of the State of Mississippi for the purposes of resolving any dispute arising under or in connection with this Agreement and irrevocably waives, to the fullest extent permitted by law, any objection which it may now or hereinafter have to any such proceedings.

11. **Customer Assistance.** Customer understands and agrees that it will use reasonable efforts in performing assistance and support for MPC as MPC performs its obligations hereunder. Any delays, facilities unavailability, tardiness in response or Customer fault (other than force majeure events) will constitute grounds for an equitable adjustment in MPC's compensation and extension of performance periods.

12. **Environmental Concerns.** If and to the extent that any Services are performed in connection with, on, or regarding any real property, MPC disclaims any and all responsibility for or concerning any present or past disposal of pollutants, dangerous substances, toxic substances, hazardous wastes, hazardous materials or hazardous substances as defined in or pursuant to the Comprehensive Environmental Response Compensation Liability Act, as amended (42 U.S.C. § 9601 et. seq.), and the Resource Conservation and Recovery Act, as amended (42 U.S.C. § 6901 et. seq.), or any other environmental law, ordinance, rule or regulation, other industrial and solid wastes and other pollutants, contaminants and dangerous and toxic substances (collectively "Hazardous Substances") on or in such real property, and for or concerning any conditions with respect to soil, surface waters, ground waters, stream settlements and similar environmental conditions (collectively, "Environmental Conditions") on or off site of such real property, whether any or all of the above arises or results from the activities of Customer or the uncertain or unknown activities of Customer's predecessors in interest to such real property or any other person or entity. It is Customer's sole obligation, as its own cost and expense (and at the request of MPC should MPC discover any Hazardous Substances on or Environmental Conditions at such real property), to comply or to ensure compliance with, and for all matters arising out of all laws, ordinances, rules and regulations, agreements with governmental entities and court and administrative orders with respect to or regarding any Hazardous Substances, Environmental Conditions and/or any other circumstances, activity and/or incident referenced in the previous sentence, including without limitation the performance of any and all necessary or appropriate remedial action thereto or

therefore. To the extent permitted by law, Customer agrees to indemnify MPC, its affiliates and their respective employees, officers, agents and directors from and against all injuries, losses, damages, costs, expenses and other liabilities, including without limitation, attorneys' fees and expenses of litigation, which may arise out of, result from or be connected with any Hazardous Substances, Environmental Conditions and/or any other circumstances, activity and/or incident referenced in the previous two sentences. Customer warrants that it has not caused or permitted any activity on such real property that generates, manufactures, refines, transports, treats, stores, handles, disposes, transfers, produces or processes Hazardous Substances, except in compliance with all applicable laws, ordinances, rules and regulations, agreements with governmental agencies and court and administrative orders, and has not caused or permitted and has no knowledge of the release, spilling, leaking, pumping, pouring, emitting, emptying, discharging, injecting, escaping, disposing or dumping of any Hazardous Substances on or off the site of such real property. Customer agrees to indemnify MPC, its parent and affiliates and their respective employees, officers, agents and directors from and against all injuries, losses, damages, costs, expenses and other liabilities, including without limitation attorneys' fees and other expenses of litigation, which may arise out of, result from or be connected with any circumstances, activity and/or incident referenced in the previous sentence.

13. **Partial Invalidity.** If any provision of this Agreement is found to be unenforceable then, notwithstanding such unenforceability, this Agreement shall remain in effect and there shall be substituted for such unenforceable provision a like but enforceable provision which most nearly effects the intention of the parties. If a like but enforceable provision cannot be substituted, the unenforceable provision shall be deemed to be deleted and the remaining provisions shall continue in effect, provided that the performance, rights and obligations of the parties hereunder are not materially adversely affected by such deletion.

14. **Changes.** If Customer desires to make a change in the Scope of Work set forth in Exhibit A or to increase the time for performance, if any, of MPC's Services under this Agreement, or to adjust the amount payable to MPC under this Agreement ("Contract Price"), it may request a Change Order for a change in the project, the time for performance, and/or the Contract Price. The Change Order will become effective when it is signed by a duly authorized representative of both Customer and MPC. Without limitation, MPC shall be entitled to a Change Order extending the time for performance and/or increasing the Contract Price if: (i) A Force Majeure event causes a delay or increase in cost with respect to any aspect of the services; (ii) a change in any applicable law or regulation or any legal action prevents or delays the performance of any aspect of the Services or increases the cost of any aspect of the Services; (iii) MPC is delayed at any time in the progress of performing its obligations under this Agreement by an act of Customer or any contractor or other entity employed by Customer; or (iv) if conditions are encountered at Customer's facilities which were concealed or differ from those indicated in this Agreement or any attachment hereto, or are unknown physical conditions of an unusual nature which differ from those ordinarily found to exist in similar activities of the character provided for by this Agreement.

15. **Right to Subcontract.** It is understood and agreed that MPC shall have the right to subcontract all of its performance obligations under this Agreement, including, but not limited to, the provision of equipment, installation, warranty and maintenance services set forth herein; provided however, that MPC shall remain responsible to Customer for all obligations so subcontracted. Customer agrees that any such subcontractor shall be entitled to access and use the Customer's facility for the performance of Services subcontracted by MPC. Customer agrees to provide any subcontractor designated in writing by MPC to perform its obligations hereunder, with a copy of any notice required to be given to MPC by Customer hereunder.

16. **Disputes.** The parties agree to use reasonable efforts to resolve any and all disputes arising under or in connection with this Agreement by mutual consultation. However, if any dispute exists which remains unresolved longer than ten (10) business days from the date on which one party notifies the other party of such dispute in writing, then either party may refer such dispute to final, exclusive, and binding resolution pursuant to arbitration before the American Arbitration Association, unless the parties mutually agree otherwise. Such arbitration shall be conducted in Gulfport, Mississippi, unless the parties mutually agree otherwise, in accordance with the American Arbitration Association's Construction Industry Arbitration Rules then in effect. A demand for arbitration shall be filed in writing with the other party to this Agreement and with the American Arbitration Association, and shall be made within a reasonable time after the claim has arisen, and in no event be made after the date when institution of legal or equitable proceedings based upon such claim would be barred by the applicable statute of limitations. Any award entered in the arbitration may be enforced by any court having competent jurisdiction thereof. No arbitration will include, by consolidation, joinder, or otherwise, parties other than MPC and Customer.

17. **Reuse of Documents.** All documents, including but not limited to, drawings, specifications, and computer software, prepared by MPC pursuant to this Agreement are instruments of service with respect to the Customer's facility. They are not intended or represented to be suitable for reuse by Customer or others on extensions of the Customer's facility or on any other project. Any reuse without prior written verification or adaptation by MPC for the specific purpose intended will be at Customer's sole risk and without liability or legal exposure to MPC, its parent or affiliates. Customer shall defend, indemnify and hold harmless MPC, its parent and affiliates against all claims, losses, damages, injuries, and expenses, including attorneys' fees, arising out of or resulting from such reuse.

18. **Entire Agreement.** This Agreement contains the entire agreement of the parties and there are no oral or written representations, understandings or agreements between the parties respecting the subject matter hereof that are not fully expressed herein.

DESCRIPTION

The EPIC Collection delivers custom luminaire flexibility with high quality, yet availability expectations of standard specification grade product. The EPIC Collection can be dressed to suit any application. Recognizing evolving environmental and legislative trends, the EPIC Collection delivers world class LED optical and performance solutions to the decorative luminaire marketplace.

Catalog #		Type
Project		
Comments		Date
Prepared by		

SPECIFICATION FEATURES

Construction

TOP: Cast aluminum top housing attaches to cast aluminum mounting arm hub with four stainless steel fasteners. One-piece silicone gasket between mounting hub and top casting seals out moisture and contaminants. (See the mounting accessories section for a full selection of mounting arms. (Only these arms are compatible with the Epic luminaire). **MIDSECTION:** Continuous silicone gaskets seal lens to top casting and shade. The mid section features cast aluminum construction and stainless steel assembly. **SHADES:** Heavy gauge precision spun aluminum shades offer superior surface finish and consistency in form. **DOORFRAME:** Die-cast aluminum 1/8" thick door and doorframe seal to underside of shade with a thick wall continuous silicone gasket. Mounting hub ships attached to mounting arm.

Optics

Choice of twelve patented, high-efficiency AccuLED Optic™ technology manufactured from

injection-molded acrylic. Optics are precisely designed to shape the optics, maximizing efficiency and application spacing. AccuLED Optic technology, creates consistent distributions with the scalability to meet customized application requirements. Offered Standard in 4000K (+/- 275K) CCT and nominal 70 CRI. Optional 3000K CCT and 5000K CC. For the ultimate level of spill light control, an optional house-side shield accessory can be field or factory installed. The house-side shield is designed to seamlessly integrate with the SL2, SL3 or SL4 optics.

Electrical

LED drivers mount to die-cast aluminum back housing for optimal heat sinking, operation efficacy, and prolonged life. Standard drivers feature electronic universal voltage (120-277V 50/60Hz), 347V 60Hz or 480V 60Hz operation, greater than 0.9 power factor, less than 20% harmonic distortion, and is suitable for operation in -40°C to 40°C ambient environments. All fixtures are shipped standard

with 10kV/10kA common – and differential – mode surge protection. LightBARs feature and IP66 enclosure rating and maintain greater than 95% lumen maintenance at 60,000 hours per IESNA TM-21. Occupancy sensor and dimming options available.

Finish

Housing is finished in five-stage super TGIC polyester powder coat paint, 2.5 mil nominal thickness for superior protection against fade and wear. LightBAR™ cover plates are standard white and may be specified to match finish of luminaire housing. Standard colors include black, bronze, grey, white, dark platinum and graphite metallic. RAL and custom color matches available. Consult Outdoor Architectural Colors brochure for a complete selection.

Warranty

Five-year warranty.

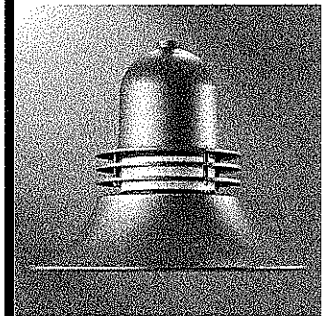

CEM/MEM EPIC MEDIUM LED

1 - 4 LightBARs
Solid State LED

DECORATIVE AREA LUMINAIRE



CERTIFICATION DATA

UL/cUL Listed
IP66 LightBARs
LM79 / LM80 Compliant
2G Vibration Tested
ISO 9001

ENERGY DATA

Electronic LED Driver
>0.9 Power Factor
<20% Total Harmonic Distortion
120-277V 50/60Hz, 347V/60Hz,
480V/60Hz
-40°C Minimum Temperature
40°C Ambient Temperature Rating

EPA

Effective Projected Area: (Sq. Ft.) 0.94

SHIPPING DATA

Approximate Net Weight:
45 lbs. [20 kgs.]

DIMENSIONS

CEM Classical

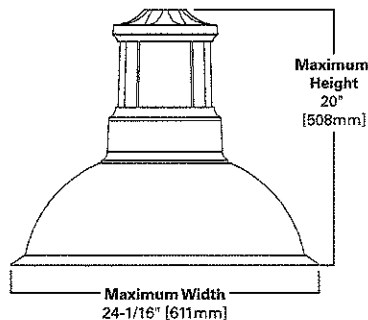

MEM Classical

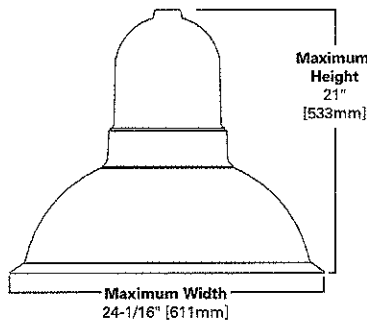

See configurations for more detailed information.

CONFIGURATIONS

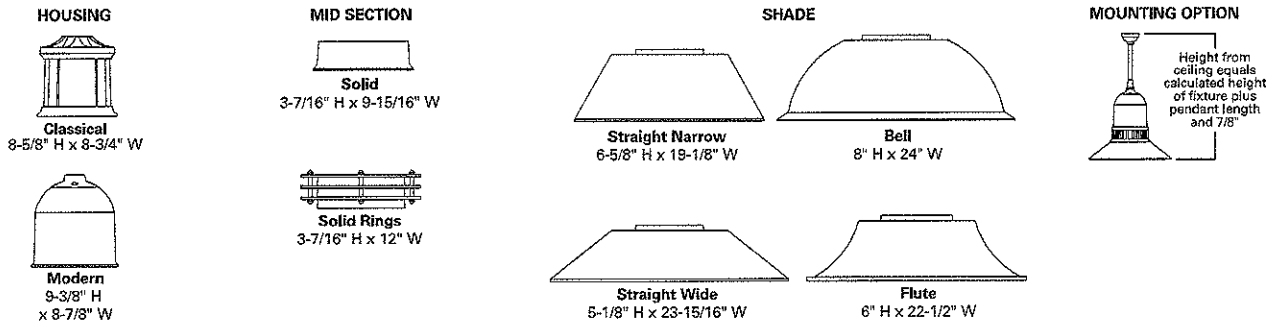

POWER AND LUMENS BY BAR COUNT (21 LED LIGHTBARS)

Number of LightBARS	E01	E02	E03	E04	
Drive Current	350mA Drive Current				
Power (Watts)	25W	52W	75W	97W	
Current @ 120V (A)	0.22	0.44	0.63	0.82	
Current @ 277V (A)	0.10	0.20	0.28	0.36	
Power (Watts)	31W	58W	82W	99W	
Current @ 347V (A)	0.11	0.19	0.28	0.29	
Current @ 480V (A)	0.09	0.15	0.20	0.21	
T2	Lumens	2,948	5,896	8,844	11,792
	BUG Rating	B1-U0-G1	B2-U0-G2	B3-U0-G3	B3-U0-G3
T3	Lumens	2,936	5,873	8,809	11,745
	BUG Rating	B1-U0-G1	B2-U0-G2	B3-U0-G3	B3-U0-G3
T4	Lumens	2,876	5,752	8,627	11,503
	BUG Rating	B1-U0-G1	B1-U0-G2	B1-U0-G2	B2-U0-G3
5MQ	Lumens	3,054	6,108	9,161	12,215
	BUG Rating	B2-U0-G1	B3-U0-G1	B3-U0-G2	B4-U0-G2
5WQ	Lumens	2,987	5,975	8,962	11,949
	BUG Rating	B2-U0-G1	B3-U0-G1	B3-U0-G2	B4-U0-G2
5XQ	Lumens	2,982	5,963	8,945	11,926
	BUG Rating	B2-U0-G1	B3-U0-G2	B3-U0-G3	B4-U0-G3
SL2	Lumens	2,878	5,756	8,634	11,512
	BUG Rating	B1-U0-G1	B1-U0-G2	B2-U0-G2	B2-U0-G2
SL3	Lumens	2,894	5,788	8,682	11,576
	BUG Rating	B1-U0-G1	B1-U0-G2	B2-U0-G2	B2-U0-G2
SL4	Lumens	2,823	5,647	8,470	11,294
	BUG Rating	B1-U0-G1	B1-U0-G2	B2-U0-G2	B2-U0-G2
RW	Lumens	2,957	5,915	8,872	11,829
	BUG Rating	B2-U0-G2	B3-U0-G3	B3-U0-G3	B3-U0-G3
SLL/SLR	Lumens	2,616	5,231	7,847	10,462
	BUG Rating	B1-U0-G2	B1-U0-G2	B1-U0-G3	B2-U0-G3

POWER AND LUMENS BY BAR COUNT (7 LED LIGHTBARS)

Number of LightBARS	F01	F02	F03	F04	
Drive Current	1A Drive Current				
Power (Watts)	26W	55W	78W	102W	
Current @ 120V (A)	0.22	0.46	0.66	0.86	
Current @ 277V (A)	0.10	0.21	0.29	0.37	
Power (Watts)	32W	60W	85W	105W	
Current @ 347V (A)	0.11	0.19	0.28	0.30	
Current @ 480V (A)	0.09	0.15	0.21	0.22	
T2	Lumens	2,434	4,867	7,301	9,735
	BUG Rating	B1-U0-G1	B2-U0-G2	B2-U0-G2	B3-U0-G3
T3	Lumens	2,424	4,848	7,272	9,696
	BUG Rating	B1-U0-G1	B2-U0-G2	B2-U0-G2	B3-U0-G3
T4	Lumens	2,374	4,748	7,122	9,496
	BUG Rating	B1-U0-G1	B1-U0-G2	B1-U0-G2	B2-U0-G2
5MQ	Lumens	2,521	5,042	7,563	10,084
	BUG Rating	B2-U0-G1	B3-U0-G1	B3-U0-G1	B3-U0-G2
5WQ	Lumens	2,466	4,932	7,398	9,864
	BUG Rating	B2-U0-G1	B3-U0-G1	B3-U0-G2	B4-U0-G2
5XQ	Lumens	2,461	4,923	7,384	9,845
	BUG Rating	B2-U0-G1	B3-U0-G2	B3-U0-G2	B4-U0-G3
SL2	Lumens	2,376	4,752	7,127	9,503
	BUG Rating	B1-U0-G1	B1-U0-G1	B2-U0-G2	B2-U0-G2
SL3	Lumens	2,389	4,778	7,167	9,556
	BUG Rating	B1-U0-G1	B1-U0-G1	B1-U0-G2	B2-U0-G2
SL4	Lumens	2,331	4,662	6,993	9,323
	BUG Rating	B1-U0-G1	B1-U0-G2	B1-U0-G2	B2-U0-G2
RW	Lumens	2,441	4,883	7,324	9,765
	BUG Rating	B1-U0-G1	B2-U0-G2	B3-U0-G3	B3-U0-G3
SLL/SLR	Lumens	2,159	4,318	6,478	8,637
	BUG Rating	B1-U0-G1	B1-U0-G2	B1-U0-G3	B1-U0-G3

LUMEN MAINTENANCE

Ambient Temperature	25,000 Hours*	50,000 Hours*	60,000 Hours*	100,000 Hours	Theoretical L70 (Hours)
25°C	> 99%	> 97%	> 96%	> 93%	> 450,000
40°C	> 98%	> 97%	> 96%	> 92%	> 425,000
50°C	> 97%	> 96%	> 95%	> 91%	> 400,000

* Per IESNA TM-21 data.

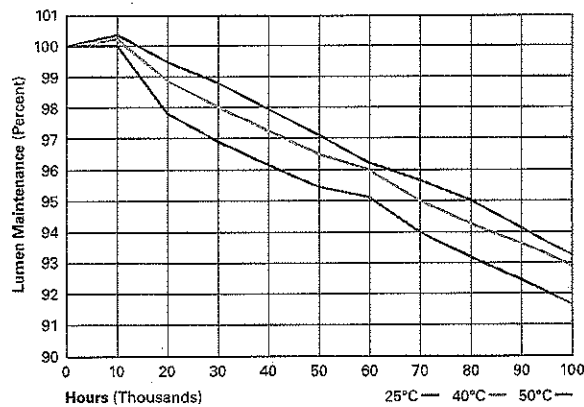

LUMEN MULTIPLIER

Ambient Temperature	Lumen Multiplier
10°C	1.02
15°C	1.01
25°C	1.00
40°C	0.99
50°C	0.96

CONTROL OPTIONS

0-10V (DIM)

This fixture is offered standard with 0-10V dimming driver(s). The DIM option provides 0-10V dimming wire leads for use with a lighting control panel or other control method.

Photocontrol (PC, PER and PER7)

Optional button-type photocontrol (PC) and photocontrol receptacles (PER and PER7) provide a flexible solution to enable “dusk-to-dawn” lighting by sensing light levels. Advanced control systems compatible with NEMA 7-pin standards can be utilized with the PER7 receptacle.

Dimming Occupancy Sensor (MS/DIM-LXX, MS/X-LXX and MS-LXX)

These sensors are factory installed in the luminaire housing. When the MS/DIM-LXX sensor option is selected, the occupancy sensor is connected to a dimming driver and the entire luminaire dims when there is no activity detected. When activity is detected, the luminaire returns to full light output. The MS/DIM sensor is factory preset to dim down to approximately 50 percent power with a time delay of five minutes. The MS-LXX sensor is factory preset to turn the luminaire off after five minutes of no activity. The MS/X-LXX is also preset for five minutes and only controls the specified number of light engines to maintain steady output from the remaining light engines.

These occupancy sensors includes an integral photocell that can be activated with the FSIR-100 accessory for “dusk-to-dawn” control or daylight harvesting - the factory preset is OFF. The FSIR-100 is a wireless tool utilized for changing the dimming level, time delay, sensitivity and other parameters.

A variety of sensor lens are available to optimize the coverage pattern for mounting heights from 8'-40'.

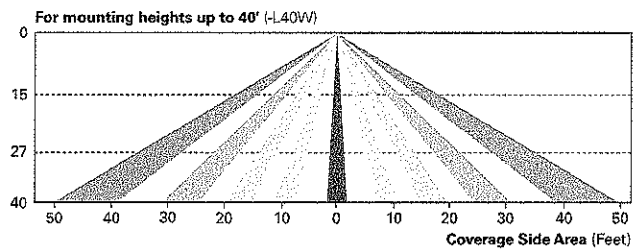
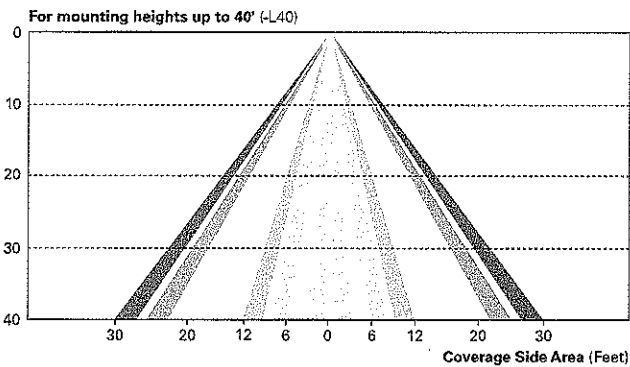
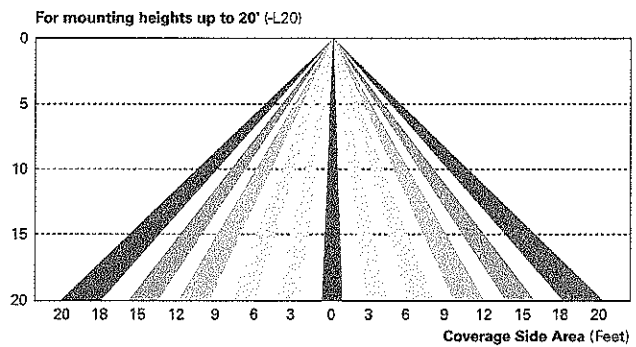
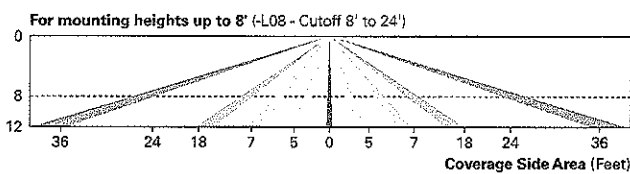

ORDERING INFORMATION

Sample Number: CEM-E04-LED-E1-T2-FL-GM

Product Family ¹	Number of LightBARs ^{2,3}	Lamp Type	Voltage	Distribution	Mid Section Type	Shade Type	Color ⁴
CEM=Epac Classical Medium MEM=Epac Modern Medium	E01=(1) 21 LED LightBAR E02=(2) 21 LED LightBARs E03=(3) 21 LED LightBARs E04=(4) 21 LED LightBARs F01=(1) 7 LED LightBAR F02=(2) 7 LED LightBARs F03=(3) 7 LED LightBARs F04=(4) 7 LED LightBARs	LED=Solid State Light Emitting Diodes	E1=Electronic (120-277V) 347=347V 480=480V ⁴	T2=Type II T3=Type III T4=Type IV SL2=Type II w/Spill Control SL3=Type III w/Spill Control SL4=Type IV w/Spill Control SMQ=Type V Square Medium 5WQ=Type V Square Wide 5XQ=Type V Square Extra Wide RW=Rectangular Wide SLL=90° Spill Light Eliminator Left SLR=90° Spill Light Eliminator Right	SO=Solid SR=Solid Rings	SN=Straight Narrow SW=Straight Wide BL=Bell FL=Flute	AP=Grey BZ=Bronze BK=Black DP=Dark Platinum GM=Graphite Metallic WH=White
Options (Add as Suffix)		Accessories (Order Separately) ¹³					
2L=Two Circuits ⁵ 7030=70 CRI / 3000K CCT ⁷ 7050=70 CRI / 5000K CCT ⁷ 8030=80 CRI / 3000K CCT ⁷ LCF=LightBAR Cover Plate Matches Housing Finish MS-LXX=Motion Sensor for ON/OFF Operation ⁸ MS/X-LXX=Motion Sensor for Bi-Level Switching ⁹ PMXX=Pendant Mount (XX=Pendant Length in Inches, 9.5" min - 48.0" max) ¹⁰ HSS=Factory Installed House Side Shield ¹¹ DIM=0-10V Dimming Driver ¹² 10MSP=Parallel 10kV MOV Surge Protective Device 20MSP=Parallel 20kV MOV Surge Protective Device 20K=Series 20kV UL 1449 Surge Protective Device		OA/RA1016=NEMA Twistlock Photocontrol - Multi-Tap OA/RA1027=NEMA Twistlock Photocontrol - 480V OA/RA1201=NEMA Twistlock Photocontrol - 347V OA/RA1013=Photocontrol Shorting Cap LB/HSS-21=Field Installed House Side Shield for "E" LightBARs ^{11,16} LB/HSS-07=Field Installed House Side Shield for "F" LightBARs ^{11,13} Mounting Accessories (Order Separately) Classical SA6150-XX=Bishop Wall Mount Arm SA6151-XX=Bishop Wall Mount Arm with Cross Rod SA6152-XX=Traditional Wall Mount Arm SA6153-XX=Traditional Wall Mount Arm with 45° Strap SA6154-XX=Bishop Single Pole Mount Arm SA6155-XX=Bishop Single Pole Mount Arm with Cross Rod SA6156-XX=Bishop Twin Pole Mount Arm SA6157-XX=Bishop Twin Pole Mount Arm with Cross Rods SA6158-XX=Traditional Single Pole Mount Arm SA6159-XX=Traditional Single Pole Mount Arm with Rounded Upper Bar SA6160-XX=Traditional Single Pole Mount Arm with Rounded Lower Bar ¹⁴ SA6161-XX=Traditional Single Pole Mount Arm with 45° Upper Bar SA6162-XX=Traditional Single Pole Mount Arm with 45° Lower Bar ¹⁴ SA6163-XX=Traditional Single Pole Mount Arm with 45° Upper Strap SA6165-XX=Traditional Twin Pole Mount Arm SA6166-XX=Traditional Twin Pole Mount Arm with Rounded Upper Bars SA6167-XX=Traditional Twin Pole Mount Arm with Rounded Lower Bars ¹⁴ SA6168-XX=Traditional Twin Pole Mount Arm with 45° Upper Bars SA6169-XX=Traditional Twin Pole Mount Arm with 45° Lower Bars ¹⁴ SA6170-XX=Traditional Twin Pole Mount Arm with 45° Upper Straps SA6171-XX=Mast Arm Adapter Modern SA6101-XX=Bishop Wall Mount Arm SA6102-XX=Bishop Wall Mount Arm with Cross Rod SA6103-XX=Traditional Wall Mount Arm SA6104-XX=Traditional Wall Mount Arm with 45° Strap SA6105-XX=Bishop Single Pole Mount Arm SA6106-XX=Bishop Single Pole Mount Arm with Cross Rod SA6107-XX=Bishop Twin Pole Mount Arm SA6108-XX=Bishop Twin Pole Mount Arm with Cross Rods SA6109-XX=Traditional Single Pole Mount Arm SA6110-XX=Traditional Single Pole Mount Arm with Rounded Upper Bar SA6111-XX=Traditional Single Pole Mount Arm with Rounded Lower Bar ¹⁴ SA6112-XX=Traditional Single Pole Mount Arm with 45° Upper Bar SA6113-XX=Traditional Single Pole Mount Arm with 45° Lower Bar ¹⁴ SA6114-XX=Traditional Single Pole Mount Arm with 45° Upper Strap SA6116-XX=Traditional Twin Pole Mount Arm SA6117-XX=Traditional Twin Pole Mount Arm with Rounded Upper Bars SA6118-XX=Traditional Twin Pole Mount Arm with Rounded Lower Bars ¹⁴ SA6119-XX=Traditional Twin Pole Mount Arm with 45° Upper Bars SA6120-XX=Traditional Twin Pole Mount Arm with 45° Lower Bars ¹⁴ SA6121-XX=Traditional Twin Pole Mount Arm with 45° Upper Straps SA6122-XX=Mast Arm Adapter					
		Accessory Options ¹⁶ V=Victorian Finial ¹⁷ M=Modern Finial ¹⁷ A=Architectural Finial ¹⁷ N=Nostalgic Finial ¹⁷ R=NEMA Twistlock Photocontrol Receptacle ¹⁸ PER7=NEMA 7-PIN Twistlock Photocontrol Receptacle ¹⁸					

NOTES:

1. Arm not included. Order separately. See accessories.
2. Standard 4000K CCT and greater than 70 Ft.
3. 21 LED LightBAR powered by 350mA and 7 LED LightBAR powered by 1A.
4. Only for use with 480V Wye systems. Per NEC, not for use with ungrounded systems, impedance grounded systems or corner grounded systems (commonly known as Three Phase Three Wire Delta, Three Phase High Leg Delta and Three Phase Corner Grounded Delta systems).
5. Custom and RAL color matching available upon request. Consult your lighting representative at Cooper Lighting Solutions for more information.
6. Low-level output varies by bar count. Consult factory. Requires quantity of two or more LightBARs.
7. Consult customer service for lead times and multiplier.
8. Sensor mounted to the luminaire. Available in E01-E04 and F01-F04 configurations. Replace "XX" with mounting height in feet for proper lens selection, (e.g., MS-L25). Consult factory for additional information.
9. Sensor mounted to the luminaire. Available in E02-E04 and F02-F04 configurations. Replace "X" with number of LightBARs operating in low output mode and replace XX with mounting height in feet for proper lens selection, (e.g., MS/3-L25). Maximum four bars in low output mode. Consult factory for additional information.
10. Pendant mount option "PMXX" must be used with InVue Pendant mount kit only. Includes pendant pipe, swivel hangar and canopy cover. Other pendant lengths can be specified in inches (XX). Minimum pendant length is 9-1/2". For lengths above 48", consult your lighting representative at Cooper Lighting Solutions for more information.
11. Only for use with SL2, SL3 and SL4 distributions.
12. Dimming leads provide for external 0-10V control system (by others).
13. Replace XX with color suffix.
14. Only available with traditional arms.
15. One required for each LightBAR.
16. Add as suffix to mounting accessory. Example: VA6106-BK-R.
17. Not available with finials, pendant mount "PM48" or bishop wall mounts.
18. Requires use of 4" O.D. round straight pole.

MOUNTING ACCESSORIES

Pole mount arms are designed to fit both medium CEM/MEM housings. (Only these arms are compatible with the Epic luminaire). Arms feature a precision welded cast aluminum mounting hub for attachment of fixture head to arm with four stainless steel fasteners. Wall mount arms compliment pole mount luminaires and attractively transition fixture scale in lower mounting height pedestrian environments. Wall mount arms are designed to fit both medium CEM/MEM housings. Arms feature a precision welded cast aluminum mounting hub for attachment of fixture head to arm with four stainless steel fasteners.

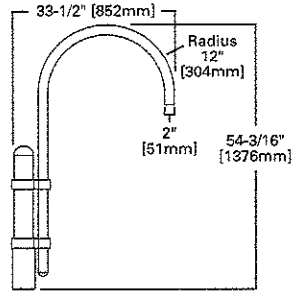

BISHOP SINGLE POLE MOUNT ARM
SA6105 (Modern), SA6154 (Classical)
Slipfits over 4" round straight pole, or 4" O.D. by 6" tall round tenon.
Weight: 24 lbs. E.P.A: 0.92

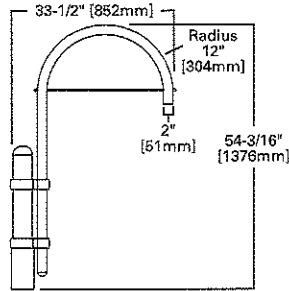

BISHOP SINGLE POLE MOUNT ARM WITH CROSS ROD
SA6106 (Modern), SA6155 (Classical)
Slipfits over 4" round straight pole, or 4" O.D. by 6" tall round tenon.
Weight: 25 lbs. E.P.A: 0.98

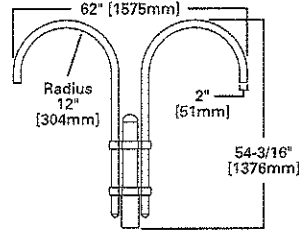

BISHOP TWIN POLE MOUNT ARM
SA6107 (Modern), SA6156 (Classical)
Slipfits over 4" round straight pole, or 4" O.D. by 6" tall round tenon.
Weight: 37 lbs. E.P.A: 1.43

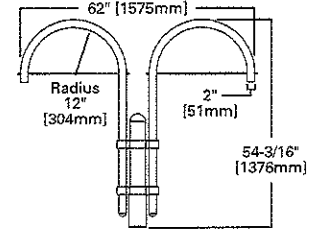

BISHOP TWIN POLE MOUNT ARM WITH CROSS RODS
SA6108 (Modern), SA6157 (Classical)
Slipfits over 4" round straight pole, or 4" O.D. by 6" tall round tenon.
Weight: 39 lbs. E.P.A: 1.55

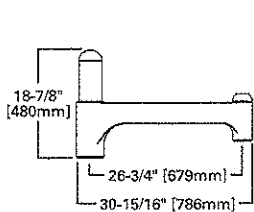

TRADITIONAL SINGLE POLE MOUNT ARM
SA6109 (Modern), SA6158 (Classical)
Slipfits over 4" round straight pole, or 4" O.D. by 6" tall round tenon.
Weight: 20 lbs. E.P.A: 0.86

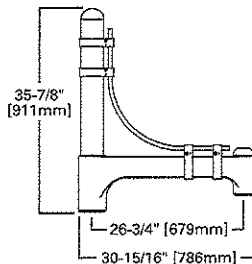

TRADITIONAL SINGLE POLE MOUNT ARM WITH ROUNDED UPPER BAR
SA6110 (Modern), SA6159 (Classical)
Slipfits over 4" round straight pole, or 4" O.D. by 6" tall round tenon.
Weight: 28 lbs. E.P.A: 1.4

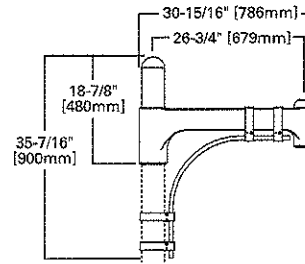

TRADITIONAL SINGLE POLE MOUNT ARM WITH ROUNDED LOWER BAR
SA6111 (Modern), SA6160 (Classical)
Slipfits over 4" round straight pole, or 4" O.D. by 6" tall round tenon.
Weight: 25 lbs. E.P.A: 1.16

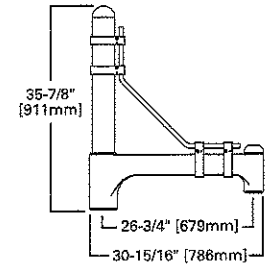

TRADITIONAL SINGLE POLE MOUNT ARM WITH 45° UPPER BAR
SA6112 (Modern), SA6161 (Classical)
Slipfits over 4" round straight pole, or 4" O.D. by 6" tall round tenon.
Weight: 28 lbs. E.P.A: 1.38

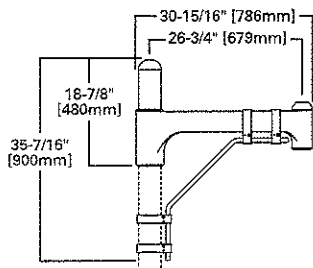

TRADITIONAL SINGLE POLE MOUNT ARM WITH 45° LOWER BAR
SA6113 (Modern), SA6162 (Classical)
Slipfits over 4" round straight pole, or 4" O.D. by 6" tall round tenon.
Weight: 24 lbs. E.P.A: 1.17

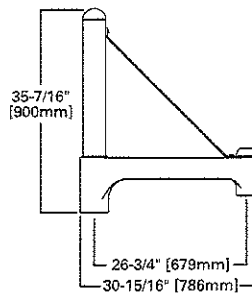

TRADITIONAL SINGLE POLE MOUNT ARM WITH 45° UPPER STRAP
SA6114 (Modern), SA6163 (Classical)
Slipfits over 4" round straight pole, or 4" O.D. by 6" tall round tenon.
Weight: 24 lbs. E.P.A: 1.17

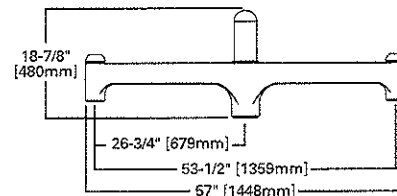

TRADITIONAL TWIN POLE MOUNT ARM
SA6116 (Modern), SA6165 (Classical)
Slipfits over 4" round straight pole, or 4" O.D. by 6" tall round tenon.
Weight: 30 lbs. E.P.A: 1.44

MOUNTING ACCESSORIES

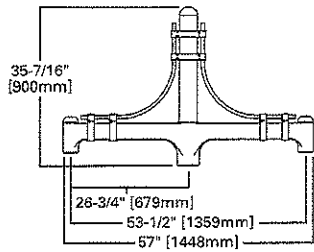

TRADITIONAL TWIN POLE MOUNT ARM WITH ROUNDED UPPER BARS
 SA6117 (Modern), SA6166 (Classical)
 Slipfits over 4" round straight pole, or 4" O.D. by 6" tall round tenon.
 Weight: 43 lbs. E.P.A: 2.28

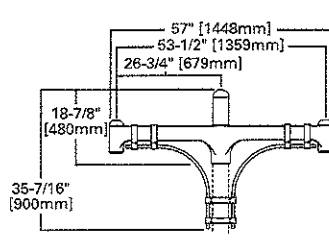

TRADITIONAL TWIN POLE MOUNT ARM WITH ROUNDED LOWER BARS
 SA6118 (Modern), SA6167 (Classical)
 Slipfits over 4" round straight pole, or 4" O.D. by 6" tall round tenon.
 Weight: 40 lbs. E.P.A: 2.04

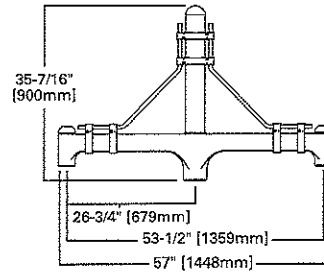

TRADITIONAL TWIN POLE MOUNT ARM WITH 45° UPPER BARS
 SA6119 (Modern), SA6168 (Classical)
 Slipfits over 4" round straight pole, or 4" O.D. by 6" tall round tenon.
 Weight: 43 lbs. E.P.A: 2.24

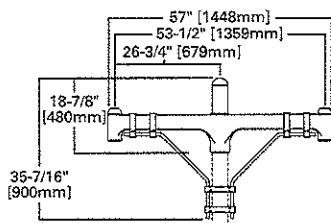

TRADITIONAL TWIN POLE MOUNT ARM WITH 45° LOWER BARS
 SA6120 (Modern), SA6169 (Classical)
 Slipfits over 4" round straight pole, or 4" O.D. by 6" tall round tenon.
 Weight: 40 lbs. E.P.A: 2.0

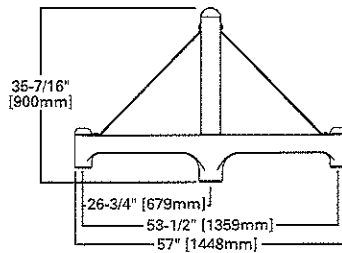

TRADITIONAL TWIN POLE MOUNT ARM WITH 45° UPPER STRAPS
 SA6121 (Modern), SA6170 (Classical)
 Slipfits over 4" round straight pole, or 4" O.D. by 6" tall round tenon.
 Weight: 37 lbs. E.P.A: 1.81

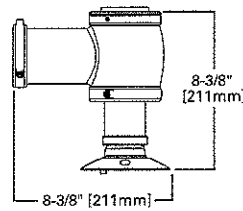

MAST ARM ADAPTER
 SA6122 (Modern), SA6171 (Classical)
 Secures fixture to nominal 2" pipe (2-3/8" horizontal O.D.)
 Weight: 4 lbs.

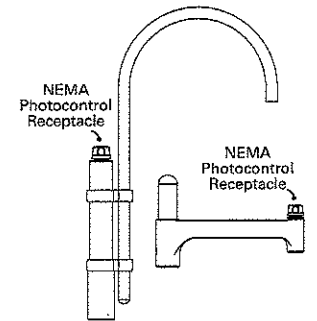

NEMA TWISTLOCK PHOTOCONTROL (R)
 Order separately (Not compatible with finials or wall mount bishop arms)

Wall Mount Accessories

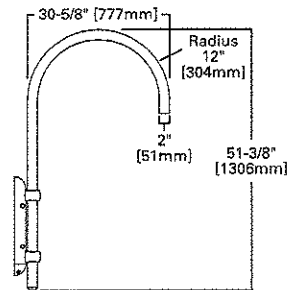

BISHOP WALL MOUNT ARM
 SA6101 (Modern), SA6150 (Classical)
 Mounts to wall with four stainless steel lag bolts (provided by other).
 Weight: 16 lbs.

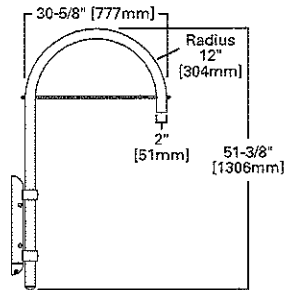

BISHOP WALL MOUNT ARM WITH CROSS ROD
 SA6102 (Modern), SA6151 (Classical)
 Mounts to wall with four stainless steel lag bolts (provided by other).
 Weight: 17 lbs.

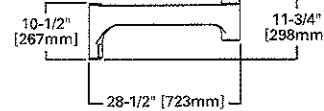

TRADITIONAL WALL MOUNT ARM
 SA6103 (Modern), SA6152 (Classical)
 Mounts to wall with four stainless steel lag bolts (provided by other).
 Weight: 17 lbs.

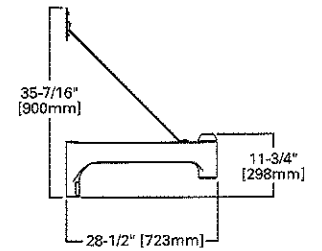

TRADITIONAL WALL MOUNT ARM WITH 45° STRAP
 SA6104 (Modern), SA6153 (Classical)
 Mounts to wall with four stainless steel lag bolts (provided by other).
 Weight: 18 lbs.