

CERTIFICATE OF SUBSTANTIAL COMPLETION

**Lighthouse Park Improvements
Pascagoula, Mississippi**

DATE OF ISSUANCE: January 17, 2022

OWNER: City of Pascagoula

CONTRACTOR: Parten Smith, Inc. ENGINEER: Brown, Mitchell & Alexander, Inc.

PROJECT: Lighthouse Park Improvements

This Certificate of Substantial Completion applies to all Work under the Contract Documents – ENTIRE PROJECT

TO: City of Pascagoula
OWNER

AND TO: Parten Smith, Inc.
CONTRACTOR

The Work to which this Certificate applies has been inspected by authorized representatives of OWNER, CONTRACTOR, AND ENGINEER, and that Work is hereby declared to be substantially complete in accordance with the Contract Documents on

December 20, 2021

DATE OF SUBSTANTIAL COMPLETION

A tentative list of items to be completed or corrected is attached hereto. This list may not be all-inclusive, and the failure to include an item does not alter the responsibility of CONTRACTOR to complete all the Work in accordance with the Contract Documents. The items on the attached tentative list shall be completed or corrected by CONTRACTOR within 60 days of the above Date of Substantial Completion.

The responsibilities between OWNER and CONTRACTOR for security, operation, safety, maintenance, utilities, insurance, and warranties and guarantees shall be as follows:

RESPONSIBILITIES

OWNER: Owner assumes responsibility for security and maintenance starting December 20, 2021.

CONTRACTOR: Contractor to complete the attached list of items to be corrected or completed and provide one full year warranty starting December 20, 2021.

The following documents are attached to and made a part of this Certificate:

Tentative List of Items to be Corrected or Completed

This Certificate does not constitute an acceptance of Work not in accordance with the Contract Documents nor is it a release of CONTRACTOR's obligation to complete the Work in accordance with the Contract Documents.

Executed by ENGINEER on

1/18/2022

Brown, Mitchell & Alexander, Inc.

CONTRACTOR accepts this Certificate of Substantial Completion on

1/18/2022

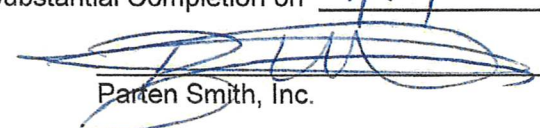
Parten Smith, Inc.

OWNER accepts this Certificate of Substantial Completion on _____

City of Pascagoula

Lighthouse Park Improvements

Walk-Through Date: 1/13/2022 - 8:30 a.m., Local Time

Attendees: Michael Silverman – City of Pascagoula
Mike West – City of Pascagoula
James Douglas – Compton Engineering
Elliot White – Parten Smith
Kevin Mullen – Brown, Mitchell & Alexander
Steve Covington – Brown, Mitchell & Alexander

LIST OF ITEMS TO BE COMPLETED OR CORRECTED

List of contract items to be addressed:

1. Clean up and seal expansion joints in the parking lot and adjacent sidewalk.
2. Address rough edges of picture framing on sidewalk.
3. Reapply joint sealant at in parking lot seem.
4. Re-seed area on west end that was disturbed while pouring the swing pads.
5. All inlet protection to be removed.
6. Cut-off extra bolt length at the court nets.
7. Crimp the remaining s-hooks on all bench swings.

During the walk through, the group identified other areas that should receive limestone surface to aid in the long-term maintenance of the park. All work associated with these additions will be completed under the current pay item in the contract and will be completed within the 60 days given for the punchlist. The additional work to be added is:

1. Adjust inlets on the East end of park adjacent to road, reshape and add limestone (see drawing).
2. Extend limestone east and west along pickleball court to the radius of existing sidewalk (see drawing).
3. Remove plants as required for the new work above.

THE PROFESSIONAL ENGINEERING SERVICES PROVIDED BY BROWN, MITCHELL & ALEXANDER, INC. (BMA) ARE RELATIVE TO THESE FINAL DRAWINGS AS SHOWN. ANY MODIFICATIONS TO THE DRAWINGS & ASSOCIATED SPECIFICATIONS AS PREPARED BY BMA WITHOUT THE WRITTEN CONSENT OF BMA, SHALL RELIEVE BMA OF ANY & ALL LIABILITY AS A RESULT OF ANY SUCH MODIFICATIONS.

CONTROL POINT/BENCH MARCH INFORMATION

BEARINGS AND DISTANCES ARE BASED ON THE MISSISSIPPI STATE PLANE GRID COORDINATE SYSTEM, NAD '83, EAST ZONE (2301), U.S. SURVEY FEET, AND WERE DERIVED USING A TOPCON HIPER VR SERIES GPS RECEIVER UTILIZING THE EARL DUDLEY, INC. REAL TIME NETWORK. ELEVATIONS ARE NAVD '88, GEOID 12B.

BM#1 - NGS MONUMENT "Z-192 RESET" (NOT SHOWN)
 N = 316974.22
 E = 1071438.93
 Z = 19.34'

BM#2 - 1/2" ROD SET W/ BLUE CAP
 N = 316968.83
 E = 1070172.04
 Z = 3.85'

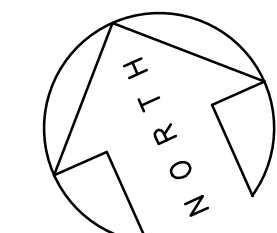

SCALE: 1"=30'

- 10'x10' CONC. VENDOR SPACE
- EXPANSION JOINT
- SWING SET AND PAD
- LIMESTONE PAVEMENT
- CONCRETE PAVEMENT
- SOD

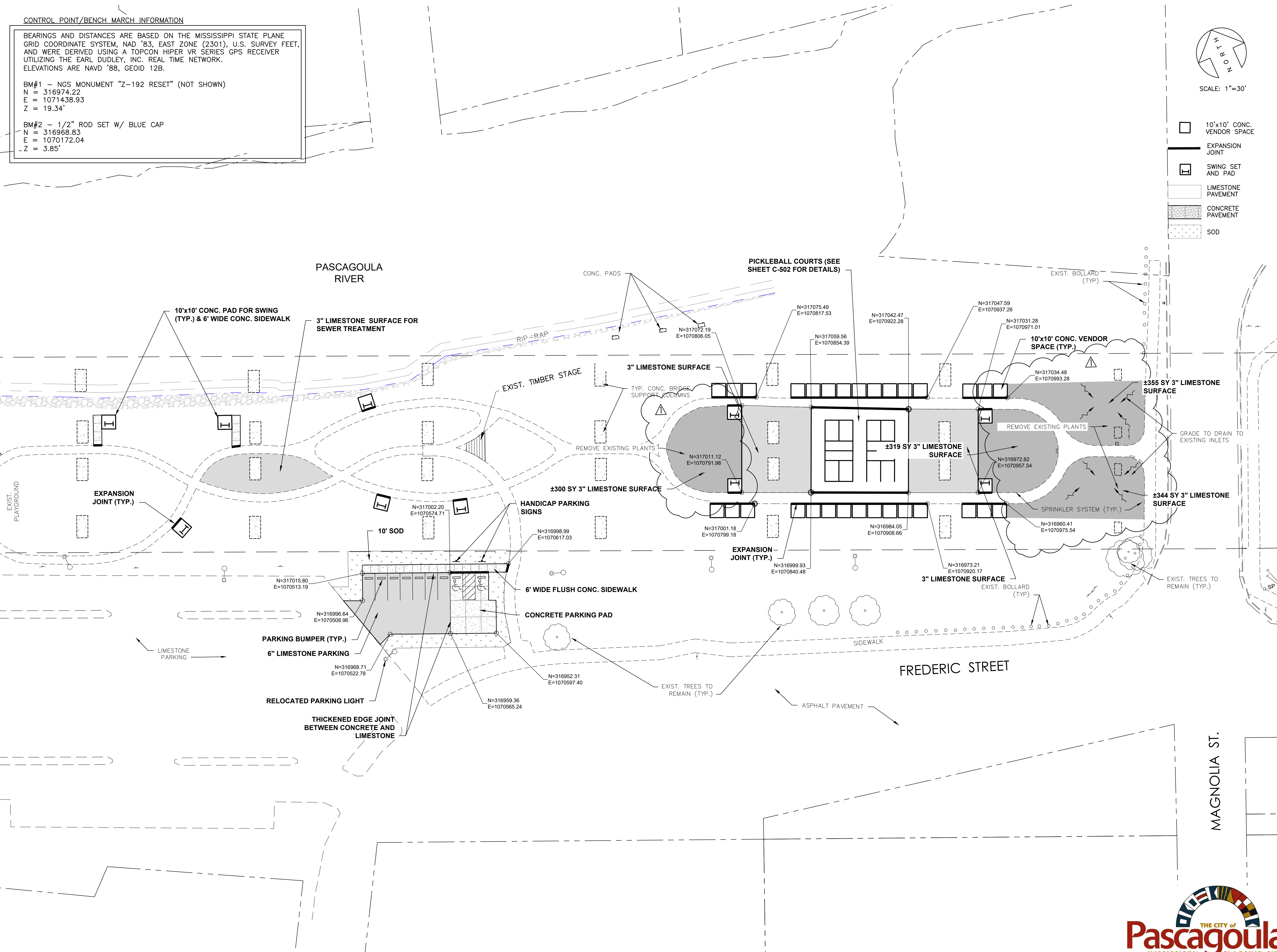

BROWN, MITCHELL & ALEXANDER, INC.
 CONSULTING ENGINEERS
 www.bmaengineers.com



SEAL
 DAVID B. ALEXANDER
 REGISTERED PROFESSIONAL ENGINEER
 14208
 MISSISSIPPI
 7/21/21

REV	DATE BY
1	1/17/22 CPN

LIGHTHOUSE PARK IMPROVEMENTS
 CITY OF PASCAGOULA
 PASCAGOULA, MISSISSIPPI
 SITE PLAN (ADDITIONAL WORK)

CAD	DME
ENG	KJM
DATE	03-29-2021
SCALE	1"=30'
BMA#	3540-01
FILE	3540-01 SITE

SHEET
C-121

